

<b>AERODROME CHART</b>	<b>ARP 671609N 0142155E</b>	<b>BODØ, BODØ</b>
<b>ICAO</b>	<b>AD ELEV 44</b>	<b>NORWAY</b>

**NOTES - REMARKS**

- APCH RWY 07: XBAR AT 150, 300, 450, 600 AND 750 M. INNERMOST LGT 30 M FM THR. APCH LGT FLUSH WITH RWY, ON EXTENSION WESTWARDS FM THR. ICAO STANDARD.
- APCH RWY 25: XBAR AT 154, 304, 454 AND 604 M. INNERMOST LGT 34 M FM THR. SEQUENCED FLASHING LGT.
- RAG: RAG 450 M WEST OF THR 25.
- ASPHALT BETWEEN THR 07 AND END OF STRIP SAME WIDTH AND STRENGTH AS RWY.
- CAUTION! DO NOT MISTAKE PARALLEL TWY TO THE SOUTH FOR MAIN RWY.
- HELI OPS AREAS, FOR DETAILS SEE AD 2.16

Runway strength, REF AD 2.12  
 Apron surface and strength, REF AD 2.8  
 Taxiway width, surface and strength, REF AD 2.8  
 Declared distances, REF AD 2.13

**COM**

ATIS	123.900 MHZ
DEICE	121.955 MHZ
DEICE	131.750 MHZ
TWR	398.650 MHZ
TWR	118.100 MHZ

**RUNWAY**

RWY	BRG
07	071.40
25	251.45

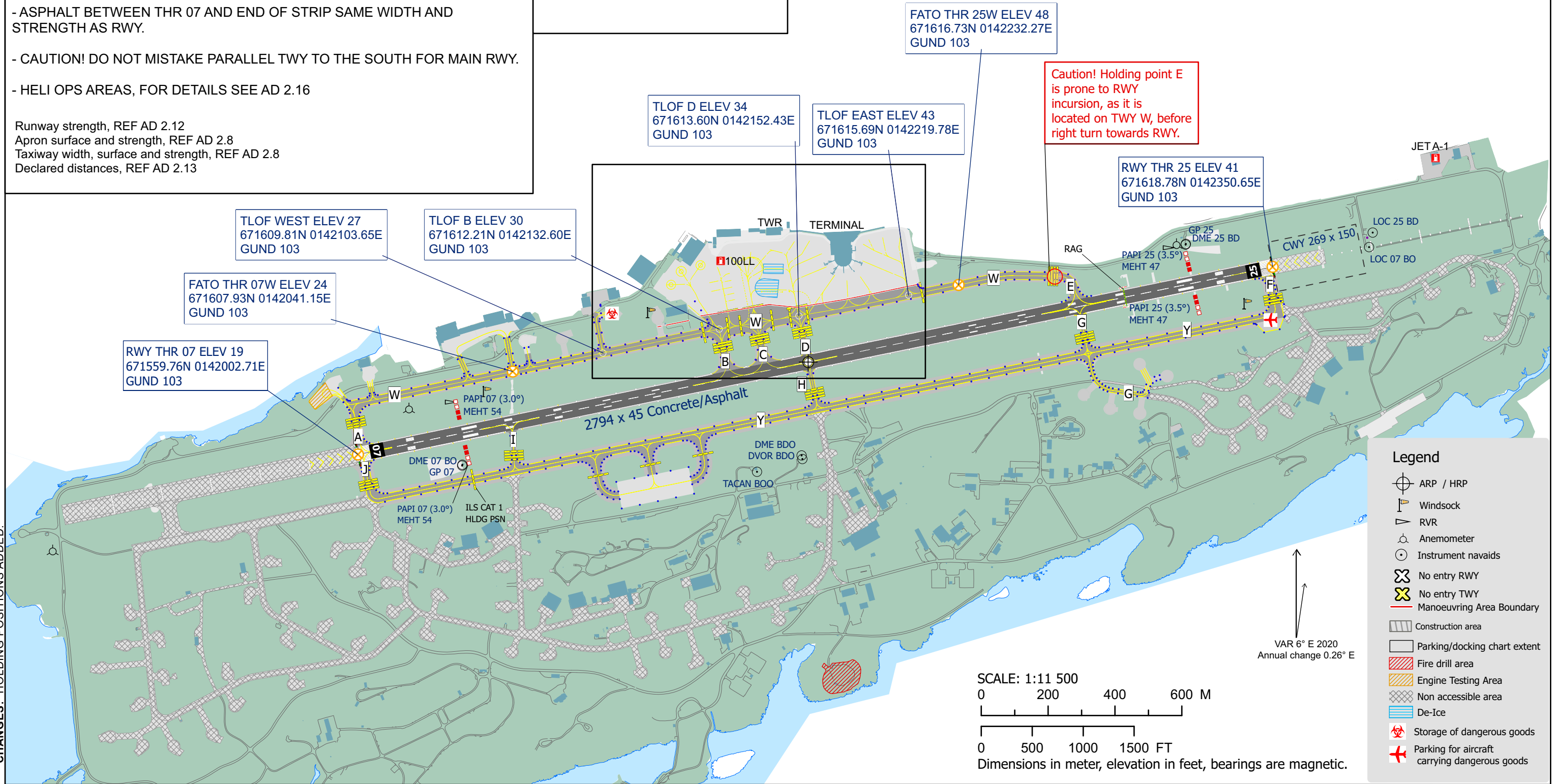

CHANGES: HOLDING POSITIONS ADDED.